

# MC 9060<sup>ex</sup>-K

## Quick Start Guide

See Product Reference Guide for more information

POST IN WORK AREA

## Battery Insertion

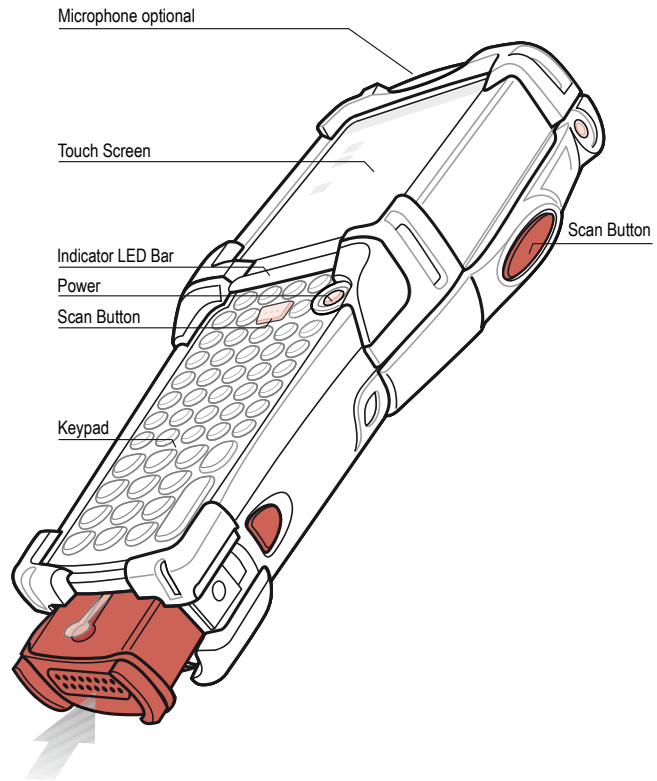
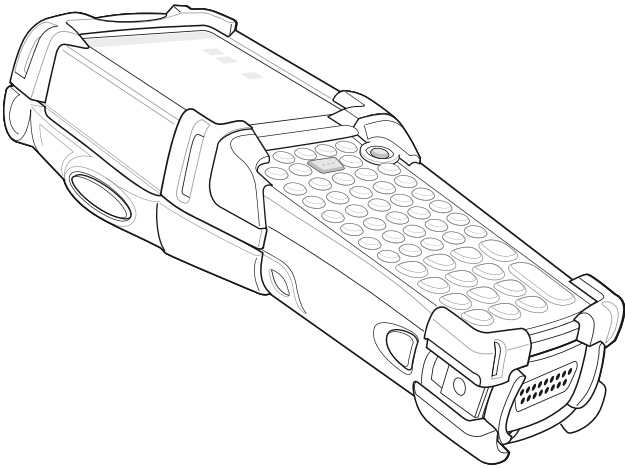

Use only I-Safe Battery, type 17-A1Z0-0001

## Battery Removal

It is allowed to replace the battery in hazardous areas.



To charge the battery in hazardous areas is strictly prohibited.

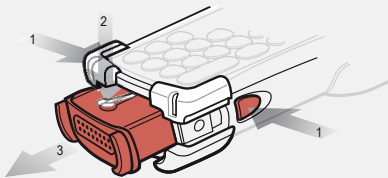

## Back View

Color Camera optional

Stylus  
Stored in strap  
Strap

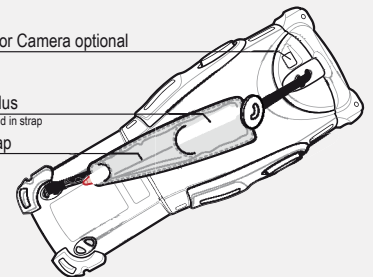

## Accessories for safe area

### Charging Instructions

Slow Flash = Normal Charge

Solid Amber = Full Charge

Fast Flash = Charging Error

= LED Indicator Location

safe area

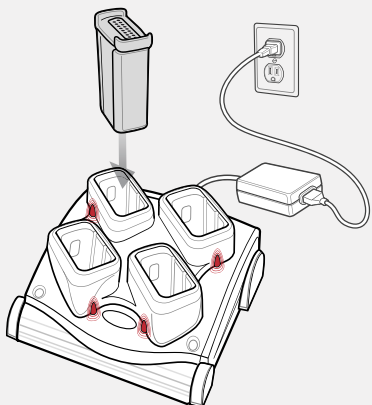

Four Slot Spare Battery Charger

safe area

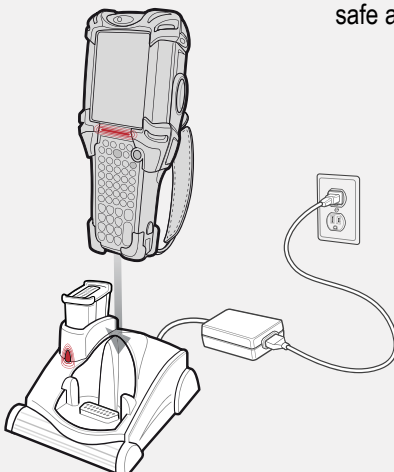

Single Slot Serial/USB Cradle

safe area

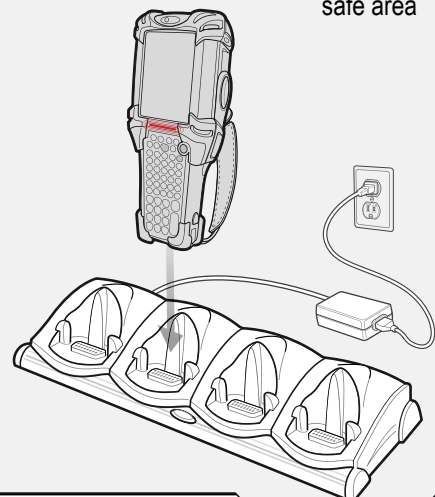

Four Slot Cradles

Charge-Only Cradle and Ethernet Cradle

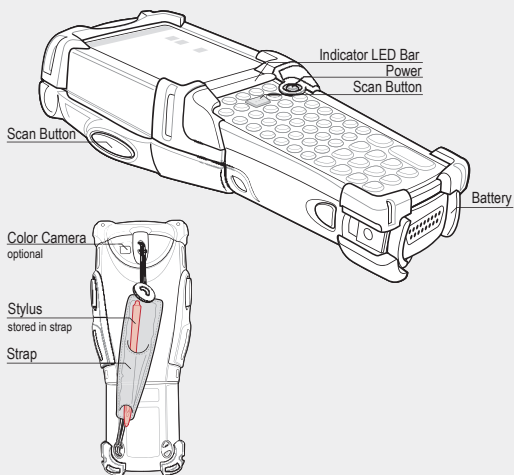

### Optimum Imaging and Scanning Positions



Scanning/Imaging

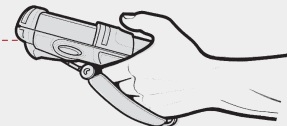

### Optimum Upright Body Posture

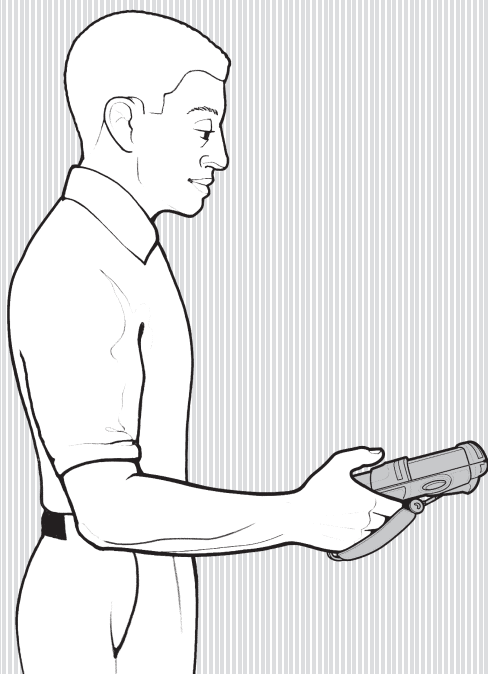

### Avoid Extreme Wrist Angles

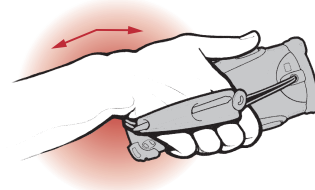
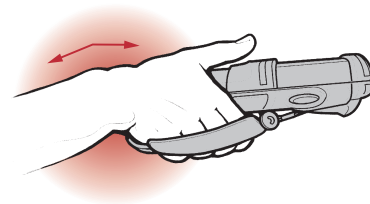

### Optimum Body Posture for Low Scanning

ALTERNATE LEFT AND RIGHT KNEES

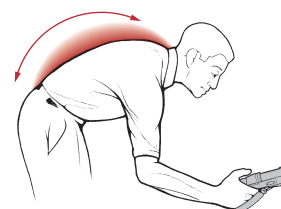
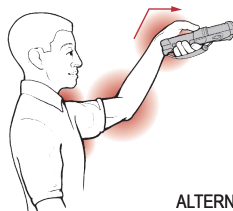

ALTERNATE LEFT AND RIGHT HANDS